

LEE COUNTY ASPHALT SURFACE TREATMENT

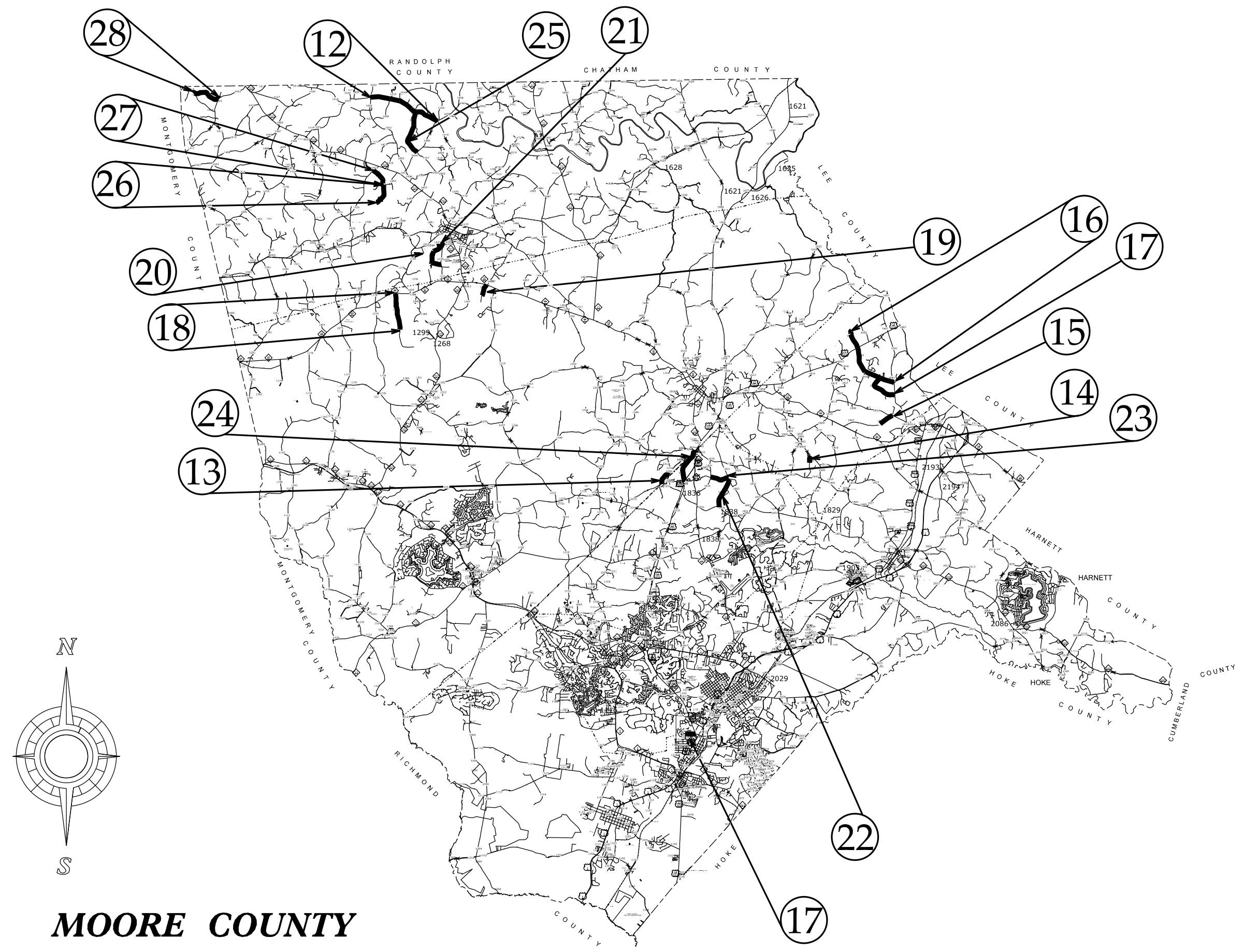

MOORE COUNTY ASPHALT SURFACE TREATMENT

3/6/2026 8:56:00 AM
I:\cadd\maps\Typ.dgn

Map 4

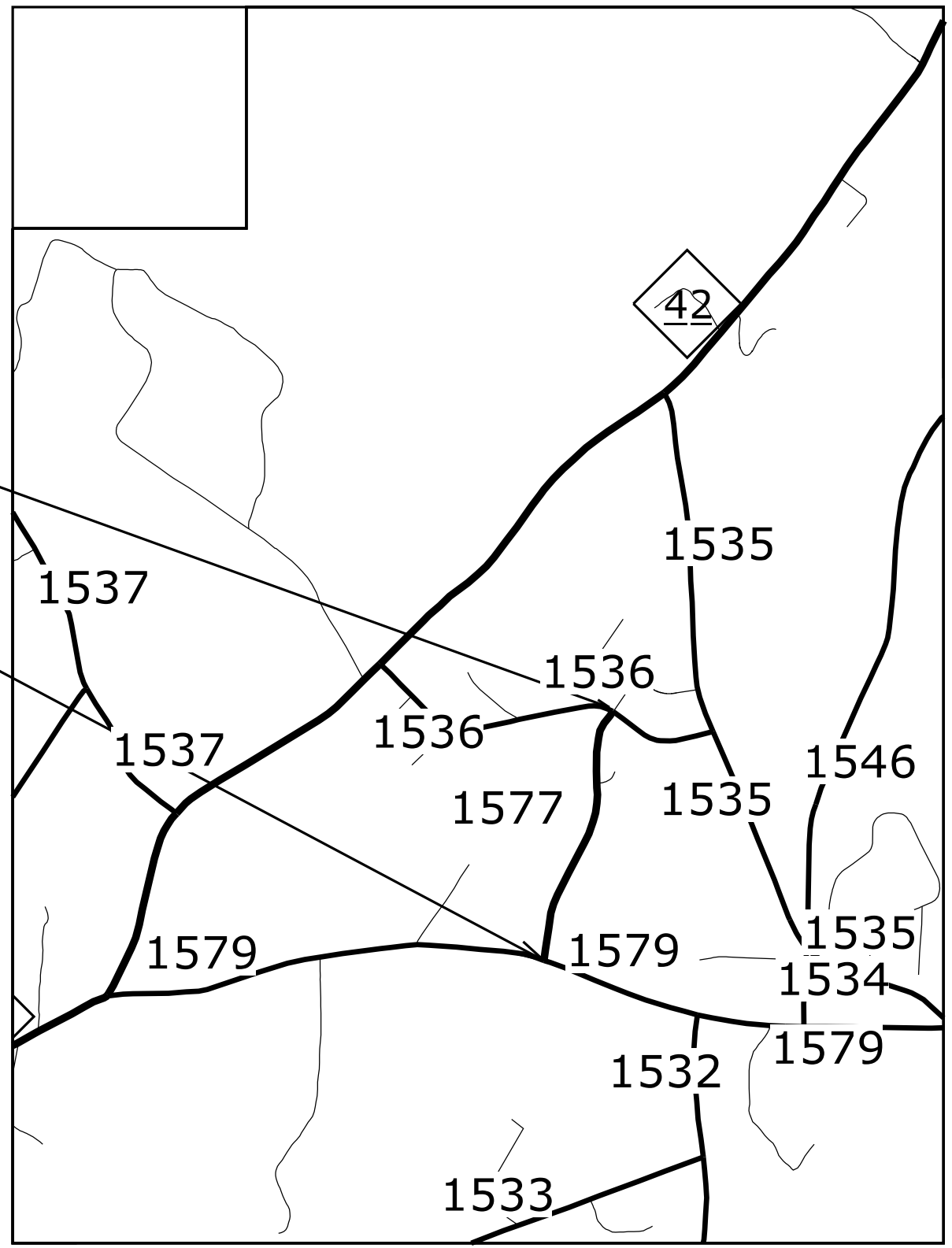

Map 5

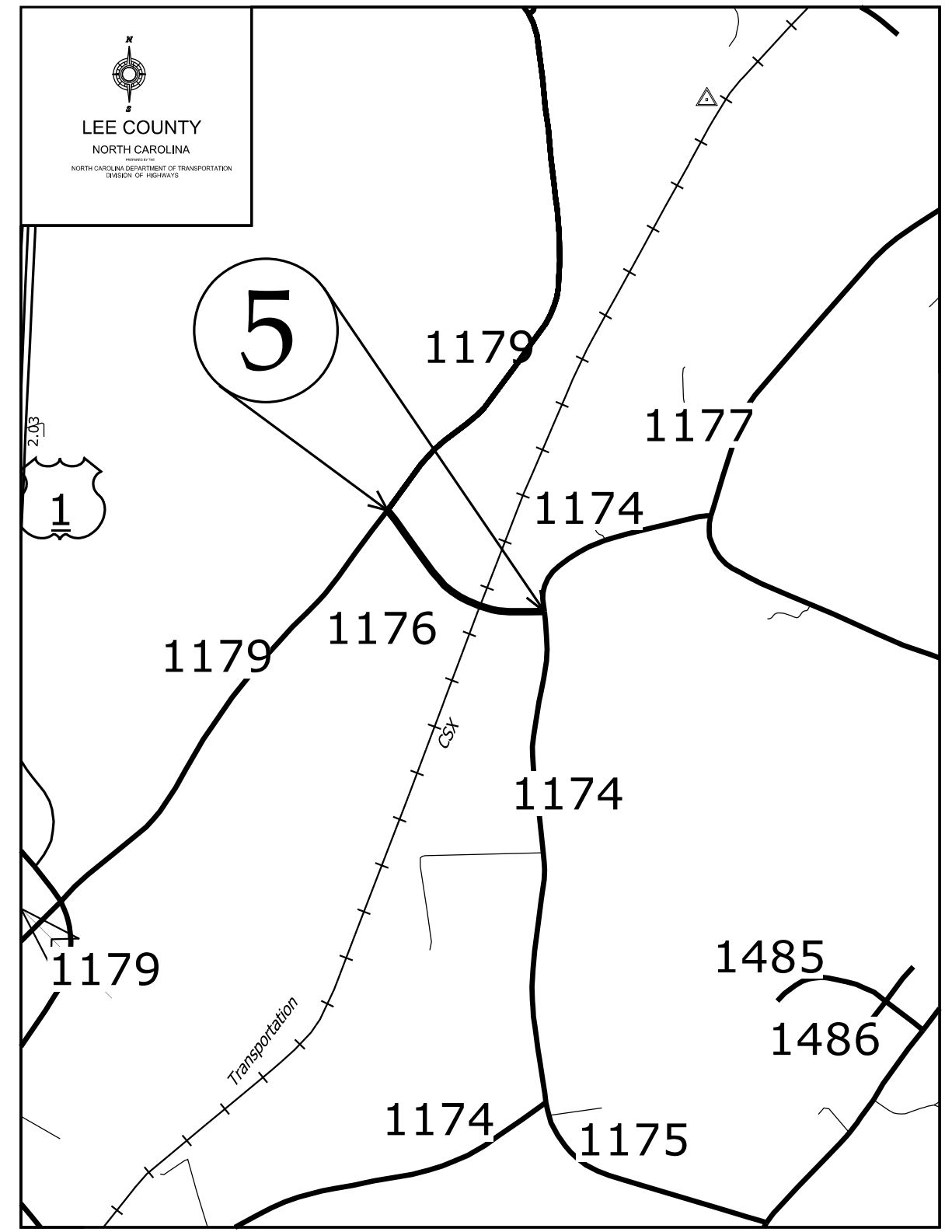

Map 11

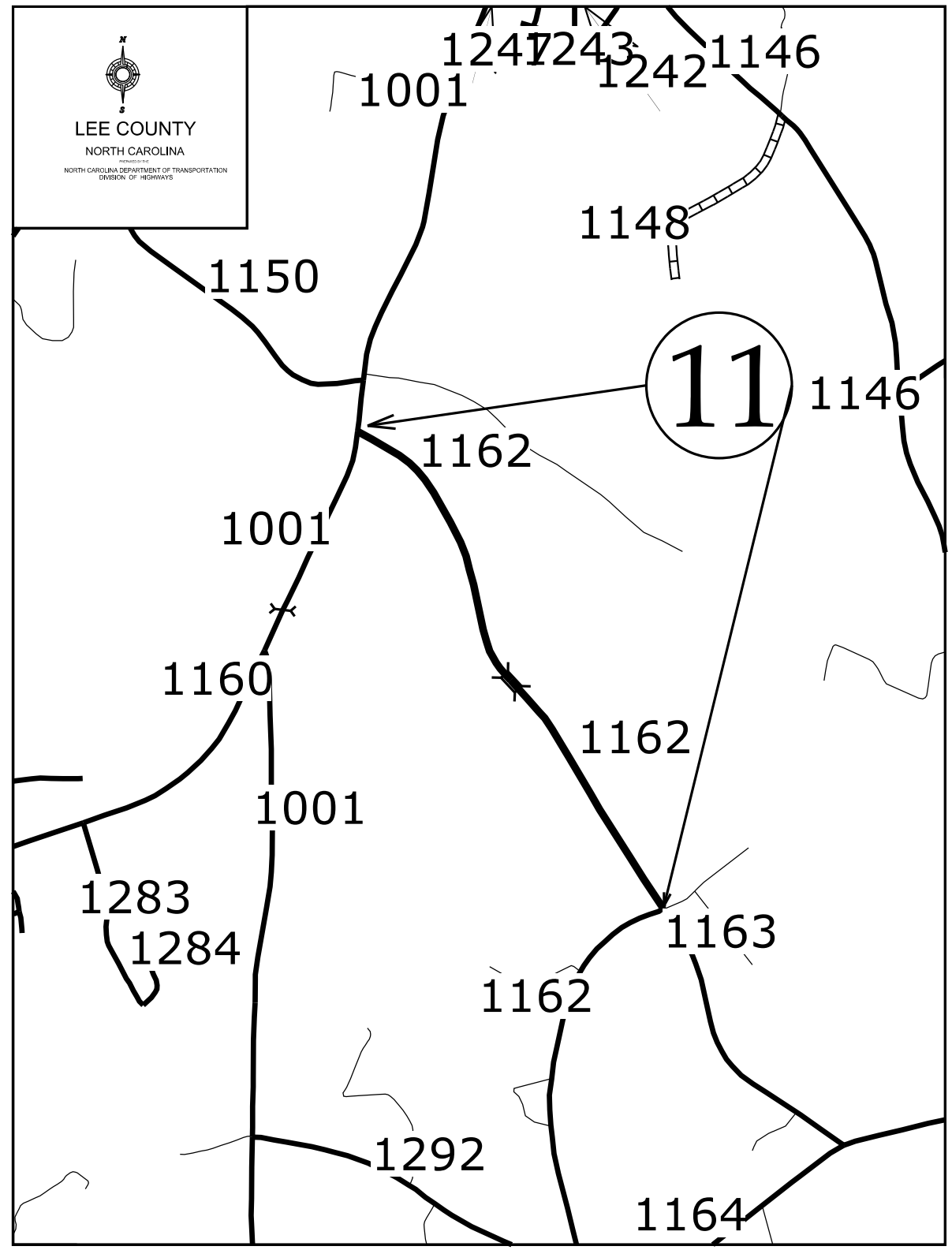

Map 12

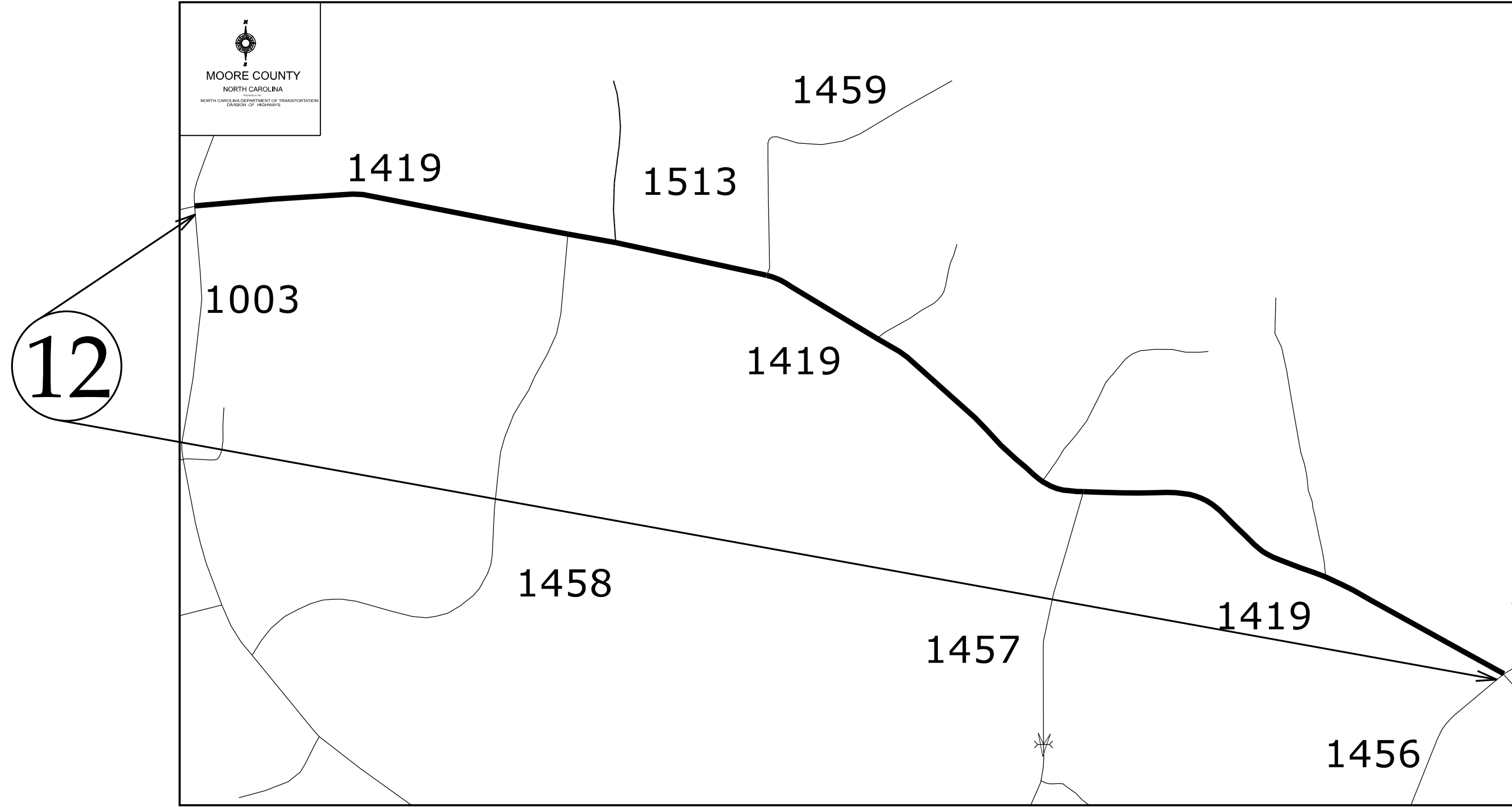

Map 13

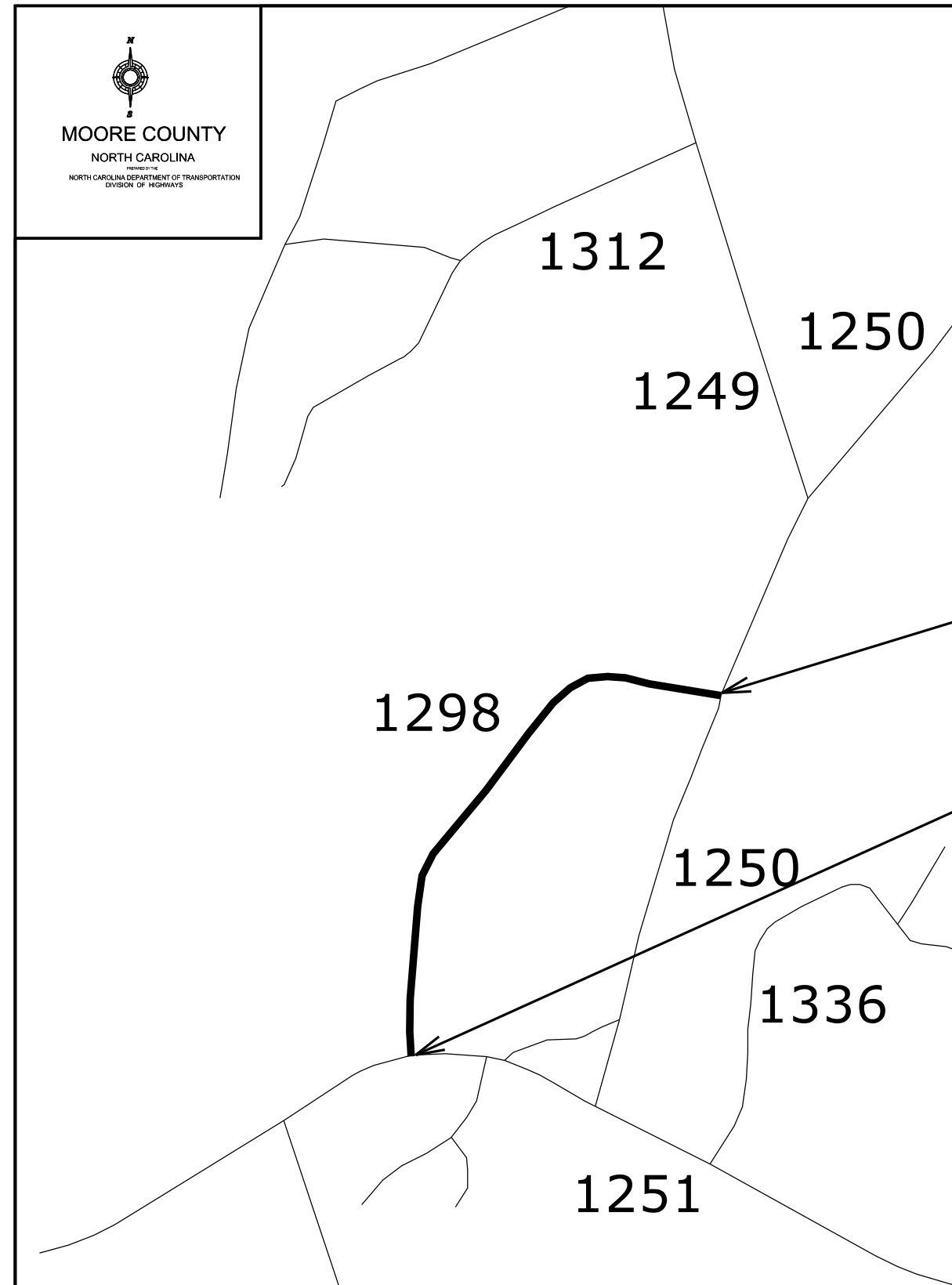

Map 14

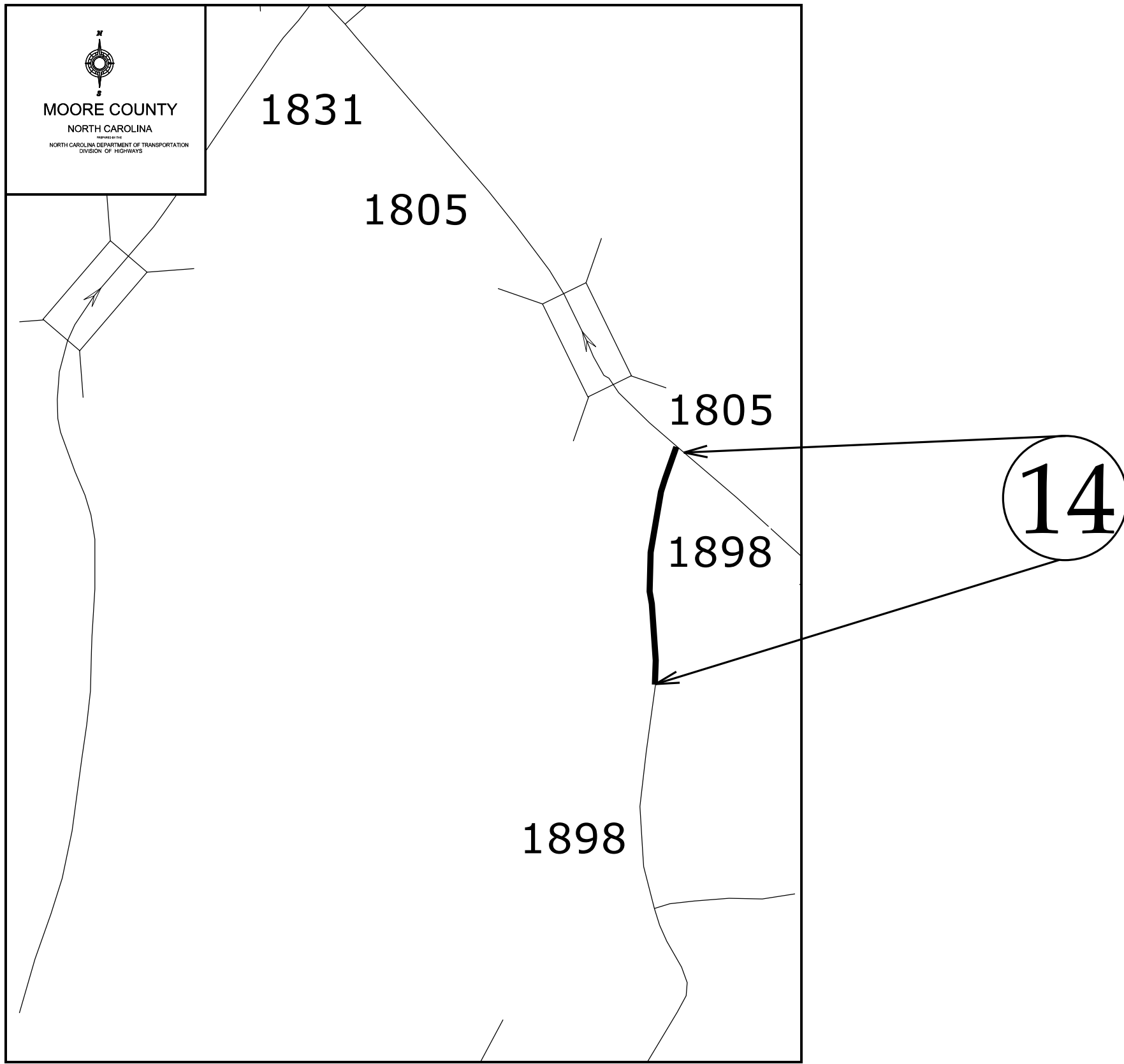

Map 15

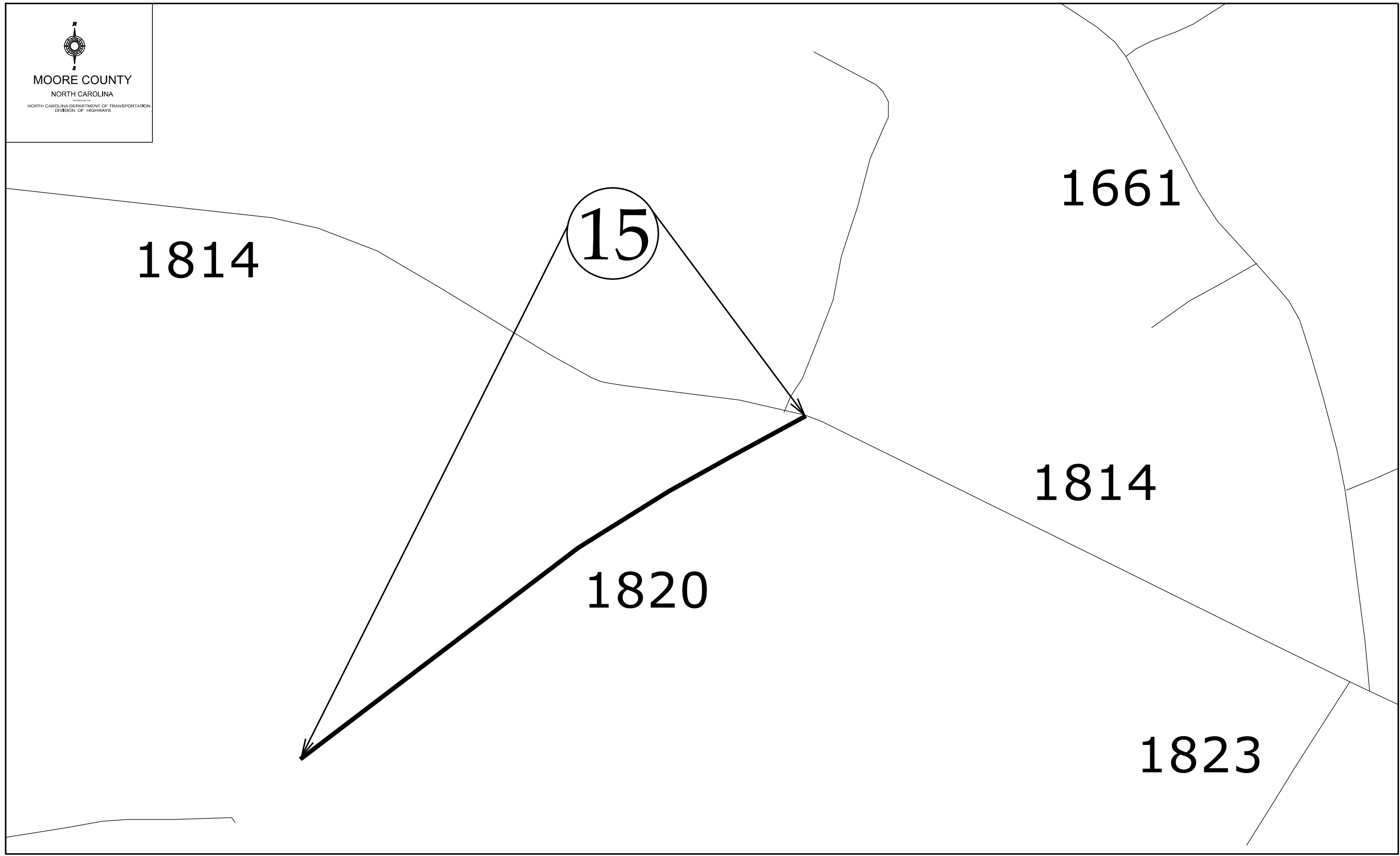

Maps 16 & 17

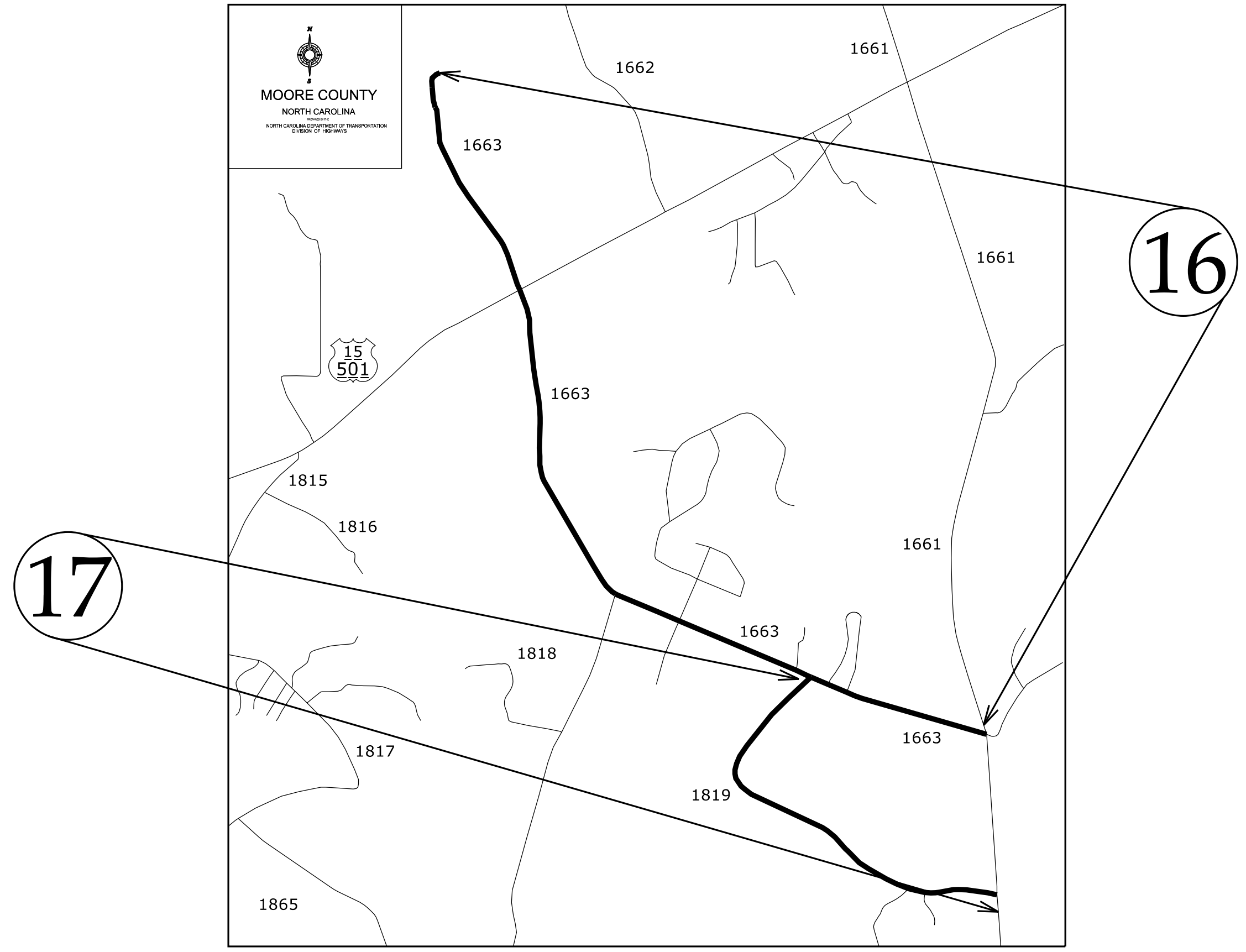

Maps 18-21

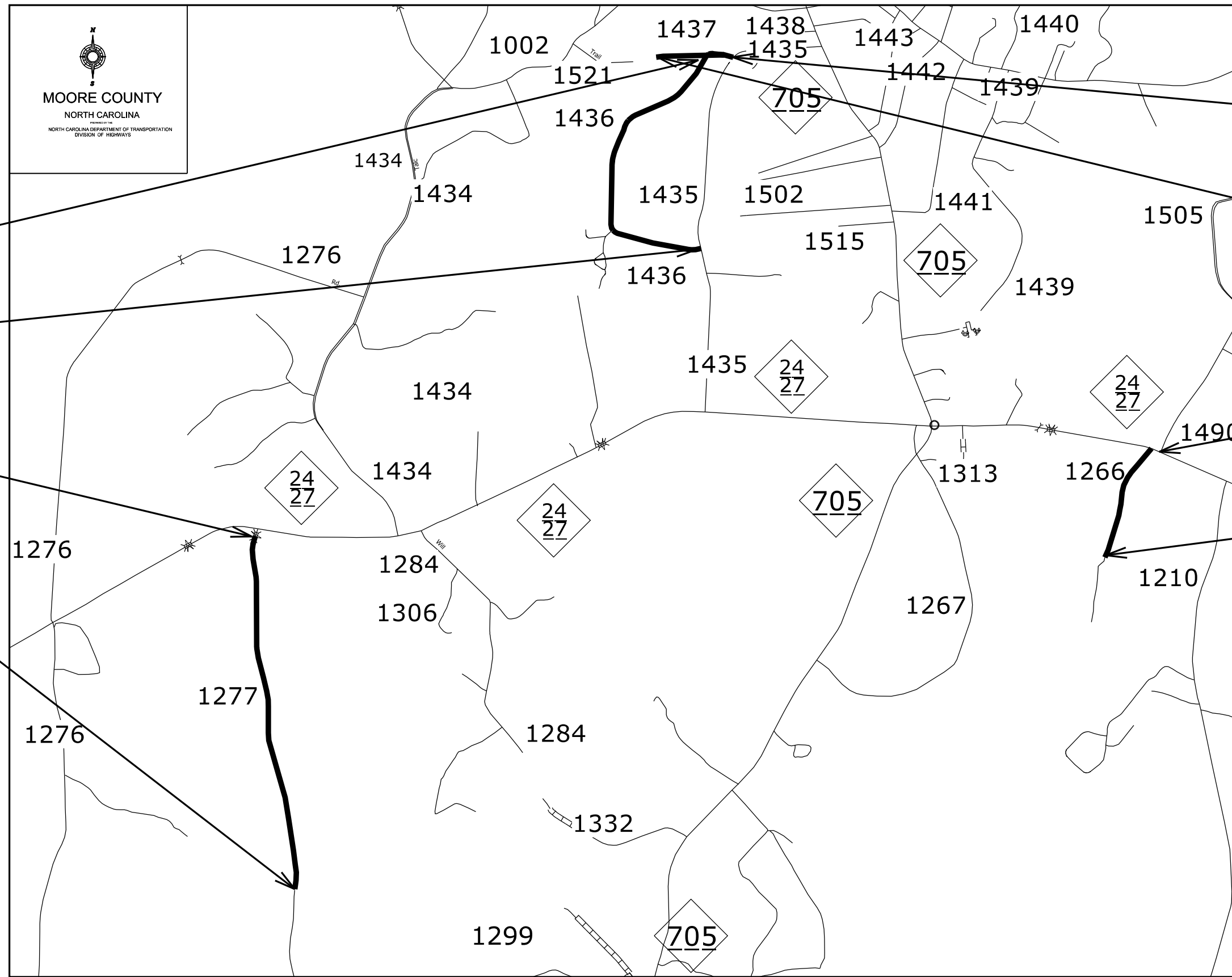

21

20

19

18

Maps 22 & 23

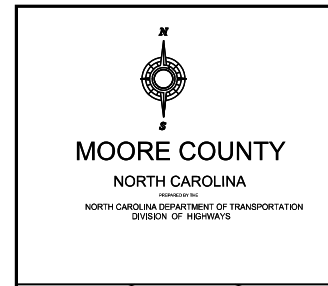
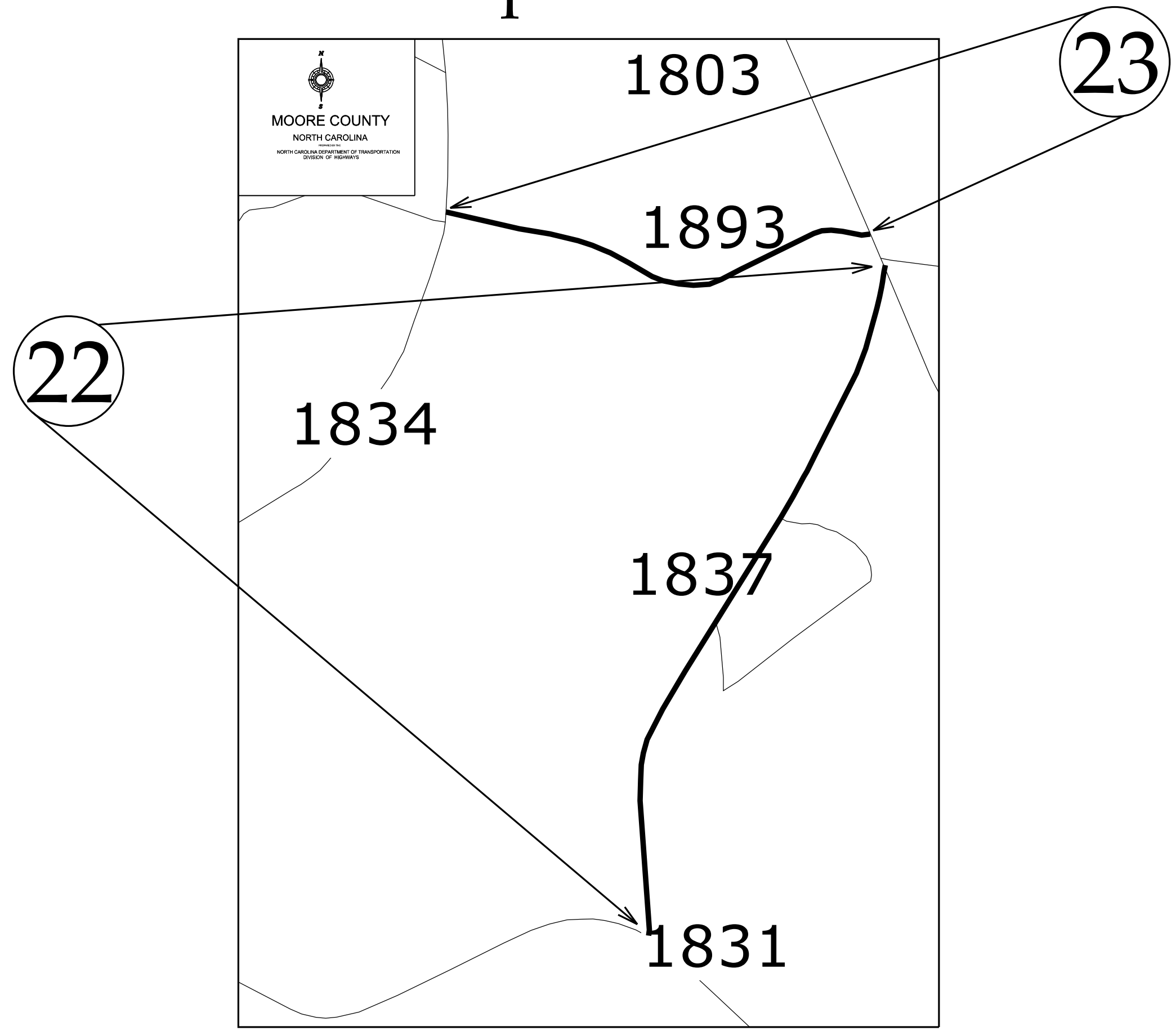

Map 24

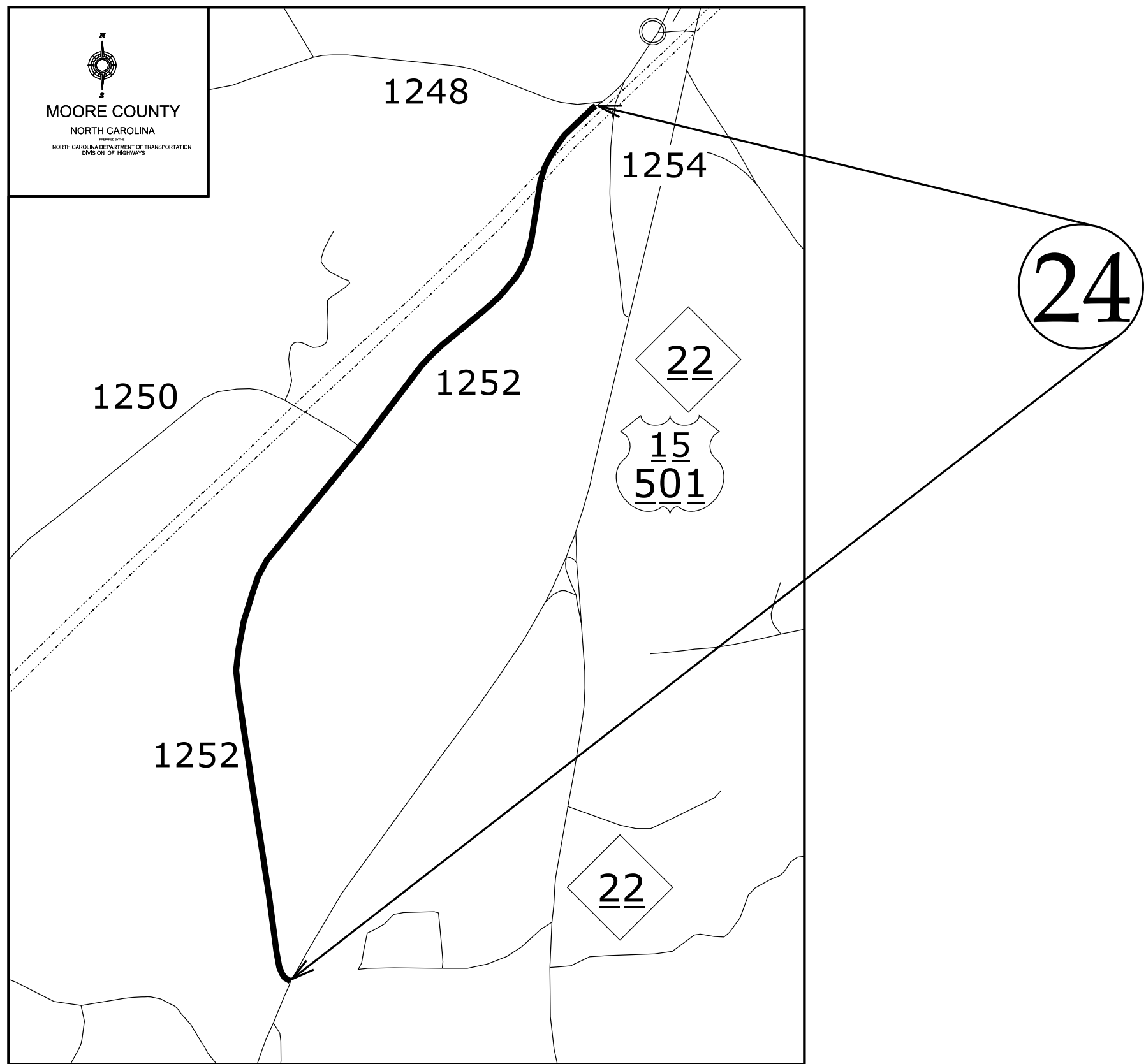

Maps 25-27

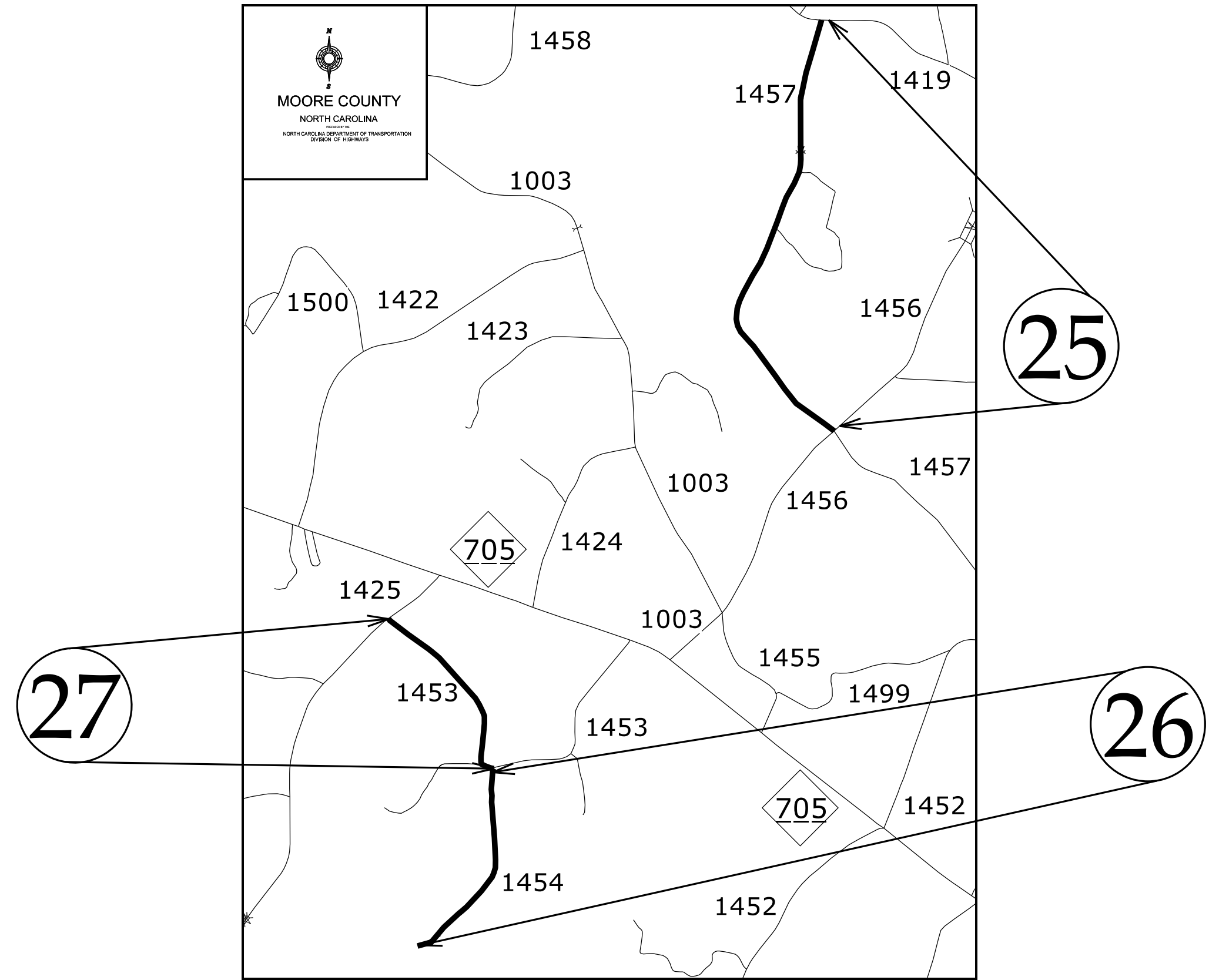

Map 28

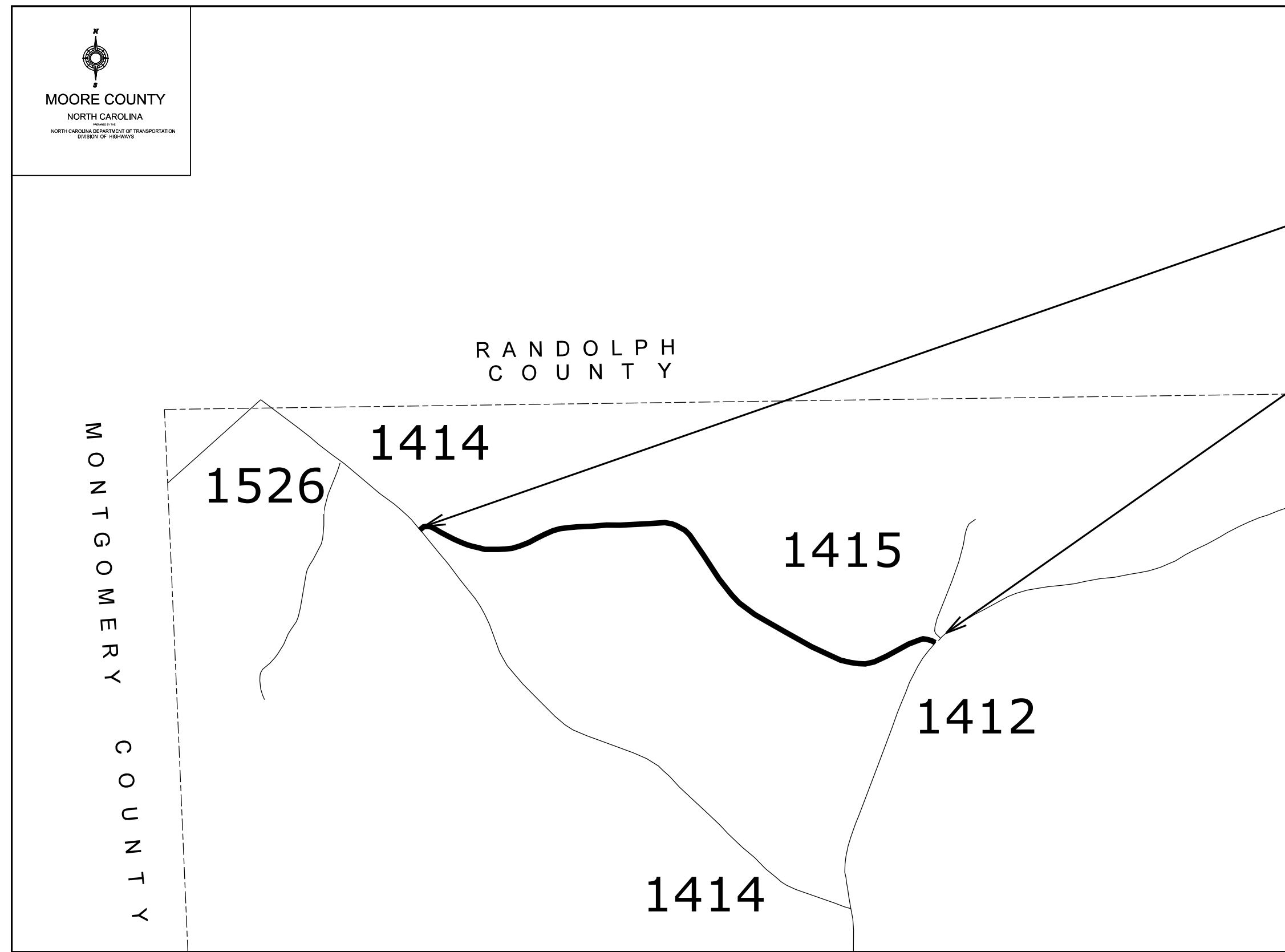

28

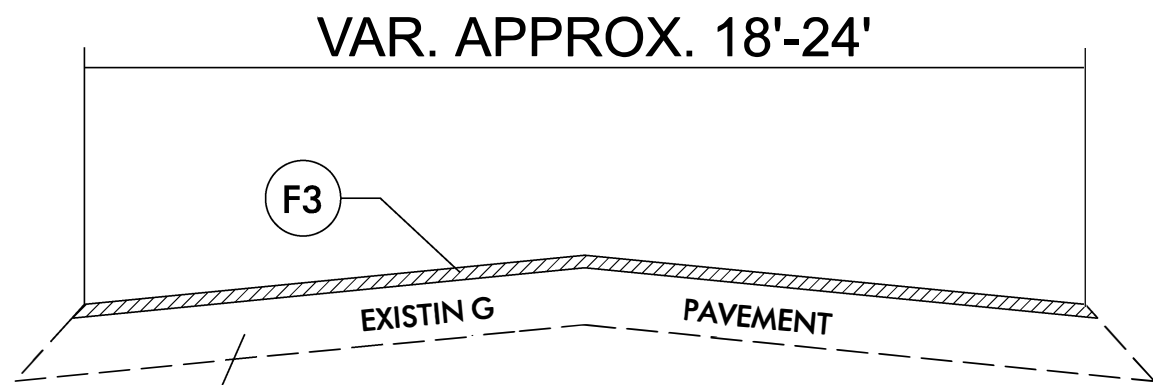

TYPICAL SECTION NO. 1
 USE FOR MAPS 1, 4, 5, 11, 13, 16-25, & 28

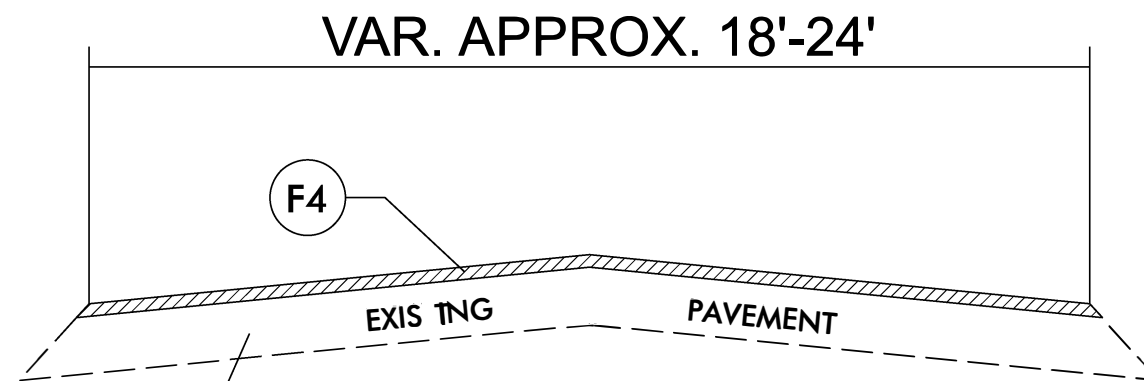

TYPICAL SECTION NO. 2
 USE FOR MAPS 3, 6-8, 10, 15 & 27

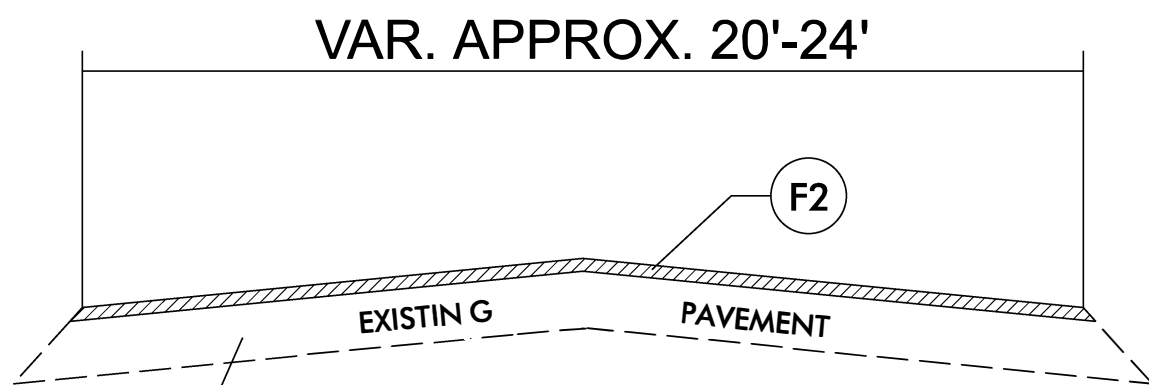

TYPICAL SECTION NO. 3
 USE FOR MAPS 2, 9, 12, & 14

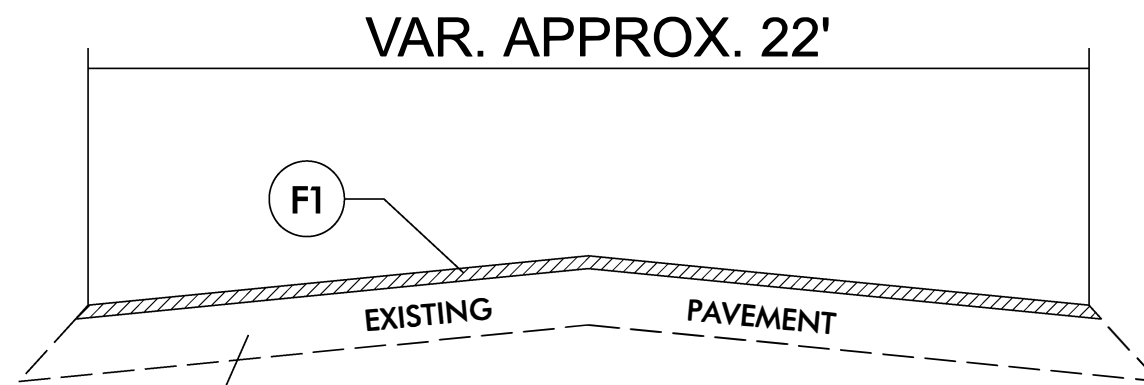

TYPICAL SECTION NO. 4
 USE FOR MAP 26

PAVEMENT SCHEDULE	
F1	PROP. ASPHALT SURFACE TREATMENT MAT & DOUBLE SEAL
F2	PROP. ASPHALT TREATMENT TRIPLE SEAL
F3	PROP. ASPHALT TREATMENT DOUBLE SEAL
F4	PROP. ASPHALT TREATMENT DOUBLE SEAL AND FOG
U	EXISTING PAVEMENT

PROJECT NO.	SHEET NO.	TOTAL NO.
2026CPT.08.07.20532, 2026CPT.08.07.20632	18	

SUMMARY OF QUANTITIES

PROJECT NO	COUNTY	MAP NO	ROUTE	DESCRIPTION	TYP NO	LANES	LANE TYPE	LENGTH	WIDTH	BEGIN MP	END MP	1575000000-E	1704000000-E	1749000000-E	1803500000-E	1820000000-E	1836000000-E	1838000000-E	1838500000-N
												ASPHALT BINDER FOR PLANT MIX	PATCHING EXISTING PAVEMENT	ASPHALT SURFACE TREATMENT, MAT & DOUBLE SEAL	ASPHALT SURFACE TREATMENT, DOUBLE SEAL	ASPHALT SURFACE TREATMENT, FOG SEAL	ASPHALT SURFACE TREATMENT, TRIPLE SEAL	EMULSION FOR ASPHALT SURFACE TREATMENT	VACUUM TRUCK
												TONS	TONS	SY	SY	SY	SY	GAL	WK
2026CPT.08.07.20532	Lee	1	SR-1419 / BRICKYARD RD	FROM SR 1415 COLON RD TO SR 1418 POST OFFICE RD	1	2	2WU	0.540	22	0.000	0.540	1	15		7,000.00			3,850	5.00
TOTAL FOR MAP NO. 1							0.540					1	15		7,000.00			3,850	
2026CPT.08.07.20532	Lee	2	SR-1418 / POST OFFICE RD	FROM SR 1415 COLON RD TO SR 1002 LOWER MONCURE RD	3	2	2WU	2.540	22	0.000	2.540	10	200				33,000.00	26,400	
TOTAL FOR MAP NO. 2							2.540					10	200				33,000.00	26,400	
2026CPT.08.07.20532	Lee	3	SR-1456 / OLD COLON RD	FROM SR 1415 COLON RD TO SR 1415 COLON RD	2	2	2WU	0.260	18	0.000	0.260		5		3,400.00	3,400.00		1,870	
TOTAL FOR MAP NO. 3							0.260						5		3,400.00	3,400.00		1,870	
2026CPT.08.07.20532	Lee	4	SR-1577 / WOODLAND TRAILS RD	FROM SR 1536 LONGSTREET RD TO SR 1579 BROADWAY RD	1	2	2WU	0.620	20	0.000	0.620	1	20		8,000.00			4,400	
TOTAL FOR MAP NO. 4							0.620					1	20		8,000.00			4,400	
2026CPT.08.07.20532	Lee	5	SR-1176 / HANCOCK CROSSING RD	FROM SR 1174 PILSON RD TO SR 1179 ROCKY FORK CHURCH RD	1	2	2WU	0.480	22	0.000	0.480	1	15		6,200.00			3,410	
TOTAL FOR MAP NO. 5							0.480					1	15		6,200.00			3,410	
2026CPT.08.07.20532	Lee	6	SR-1295 / UPCHURCH FARM RD	FROM SR 1144 SWANS STATION RD TO END OF MAINTENANCE	2	2	2WU	0.510	22	0.000	0.510		10		6,583.00	6,583.00		3,621	
TOTAL FOR MAP NO. 6							0.510						10		6,583.00	6,583.00		3,621	
2026CPT.08.07.20532	Lee	7	SR-1296 / PLANT BED LN	FROM SR 1295 (UPCHURCH FARM ROAD) TO CULDESAC	2	2	2WU	0.150	20	0.000	0.150		10		1,760.00	1,760.00		968	
TOTAL FOR MAP NO. 7							0.150						10		1,760.00	1,760.00		968	
2026CPT.08.07.20532	Lee	8	SR-1297 / PACK HOUSE RD	FROM SR 1295 (UPCHURCH FARM ROAD) TO CULDESAC	2	2	2WU	0.170	20	0.000	0.170		10		1,996.00	1,996.00		1,098	
TOTAL FOR MAP NO. 8							0.170						10		1,996.00	1,996.00		1,098	
2026CPT.08.07.20532	Lee	9	SR-1250 / PARKWOOD DR	FROM SR 1157 HICKORY HOUSE RD TO END OF MAINTENANCE	3	2	2WU	0.420	20	0.000	0.420	1	15				5,500.00	4,400	
TOTAL FOR MAP NO. 9							0.420					1	15				5,500.00	4,400	
2026CPT.08.07.20532	Lee	10	SR-1266 / WESTCHESTER DR	FROM SR 1157 HICKORY HOUSE RD TO END OF MAINTENANCE	1	2	2WU	0.360	20	0.000	0.360	1	12		4,700.00	4,700.00		2,585	
TOTAL FOR MAP NO. 10							0.360					1	12		4,700.00	4,700.00		2,585	
2026CPT.08.07.20532	Lee	11	SR-1162 / SHERIFF WATSON RD	FROM SR 1162 HOLDER RD ALL INTERSECTION TO SR 1001 LEMON SPRINGS RD	1	2	2WU	1.360	24	7.240	8.600	1	30		19,150.00			10,533	
TOTAL FOR MAP NO. 11							1.360					1	30		19,150.00			10,533	
TOTAL FOR PROJ NO. 2026CPT.08.07.20532							7.410					16	342		58,789.00	18,439.00	38,500.00	63,135	5.00
2026CPT.08.07.20632	Moore	12	SR-1419 / CEDAR HILL RD	FROM SR 1003 NEEDHAM GROVE RD TO SR 1456 N HOWARD MILL RD	3	2	2WU	2.795	24	3.160	5.955	2	50				39,500.00	31,600	
TOTAL FOR MAP NO. 12							2.795					2	50				39,500.00	31,600	
2026CPT.08.07.20632	Moore	13	SR-1298 / SHORT RD	FROM SR 1251 BRINKLEY RD TO SR 1250 JODY RD	1	2	2WU	0.500	21	0.010	0.510	1	12		6,600.00			3,630	
TOTAL FOR MAP NO. 13							0.500					1	12		6,600.00			3,630	
2026CPT.08.07.20632	Moore	14	SR-1898 / SMITH HILL RD	FROM SR 1805 UNION CHURCH RD TO END OF MAINTENANCE	3	2	2WU	0.250	20	0.010	0.260		5				3,200.00	1,760	
TOTAL FOR MAP NO. 14							0.250						5				3,200.00	1,760	
2026CPT.08.07.20632	Moore	15	SR-1820 / EDGEWOOD RD	SR 1814 RED HILL RD TO END OF MAINTENANCE	1	2	2WU	0.560	22	0.010	0.570		10		7,300.00	7,300.00		4,015	
TOTAL FOR MAP NO. 15							0.560						10		7,300.00	7,300.00		4,015	
2026CPT.08.07.20632	Moore	16	SR-1663 / LAMMS GROVE RD	FROM SR 1661 STANTON HILL RD TO END OF MAINTENANCE	1	2	2WU	2.760	22	0.010	2.770	3	60		35,800.00			19,690	
TOTAL FOR MAP NO. 16							2.760					3	60		35,800.00			19,690	
2026CPT.08.07.20632	Moore	17	SR-1819 / GRAHAM RD	FROM SR 1663 LAMMS GROVE RD TO SR 1661 STANTON HILL RD	1	2	2WU	1.255	21	0.010	1.265	1	30		16,400.00			9,020	
TOTAL FOR MAP NO. 17							1.255					1	30		16,400.00			9,020	

PROJECT NO.	SHEET NO.	TOTAL NO.
2026CPT.08.07.20532, 2026CPT.08.07.20632	19	

SUMMARY OF QUANTITIES

2026CPT.08.07.20632	Moore	18	SR-1277 / ALEX RD	FROM HWY 24/27 TO END OF MAINTENANCE	1	2	2WU	1.400	18	0.010	1.410	1	30	15,500.00			8,525	
TOTAL FOR MAP NO. 18								1.400				1	30	15,500.00			8,525	
2026CPT.08.07.20632	Moore	19	SR-1266 / CLAUDE RD	FROM HWY 24/27 TO END OF MAINTENANCE	1	2	2WU	0.460	18	0.010	0.470		10	5,100.00			2,805	
TOTAL FOR MAP NO. 19								0.460					10	5,100.00			2,805	
2026CPT.08.07.20632	Moore	20	SR-1436 / SIMMONS RD	FROM SR 1435 SUNSET DR TO SR 1435 SUNSET DR	1	2	2WU	1.245	22	0.010	1.255	1	25	16,800.00			9,240	
TOTAL FOR MAP NO. 20								1.245				1	25	16,800.00			9,240	
2026CPT.08.07.20632	Moore	21	SR-1437 / JIM RD	FROM SR 1436 SIMMONS RD TO END OF MAINTENANCE	1	2	2WU	0.200	18	0.000	0.200		6	2,600.00			1,430	
TOTAL FOR MAP NO. 21								0.200					6	2,600.00			1,430	
2026CPT.08.07.20632	Moore	22	SR-1837 / SHADY GROVE RD	FROM SR 1831 FARM LIFE SCHOOL TO SR 1803 VASS CARTHAGE RD	1	2	2WU	1.145	22	0.010	1.155	1	20	15,000.00			8,250	
TOTAL FOR MAP NO. 22								1.145				1	20	15,000.00			8,250	
2026CPT.08.07.20632	Moore	23	SR-1893 / BROWN RD	FROM SR 1834 STAR RIDGE RD TO SR 1803 VASS CARTHAGE RD	1	2	2WU	0.695	22	0.010	0.705		10	9,200.00			5,060	
TOTAL FOR MAP NO. 23								0.695					10	9,200.00			5,060	
2026CPT.08.07.20632	Moore	24	SR-1252 / SHADY LANE RD	FROM SR 1254 LEGION HUT RD TO HWY 15/501	1	2	2WU	1.400	18	0.010	1.410	1	30	15,500.00			8,525	
TOTAL FOR MAP NO. 24								1.400				1	30	15,500.00			8,525	
2026CPT.08.07.20632	Moore	25	SR-1457 / SMYRNA CHURCH RD	SR 1419 CEDAR HILL RD TO SR 1456 N HOWARD HILL RD	1	2	2WU	1.735	18	0.010	1.745	2	35	19,250.00			10,588	
TOTAL FOR MAP NO. 25								1.735				2	35	19,250.00			10,588	
2026CPT.08.07.20632	Moore	26	SR-1454 / LINEBERRY RD	FROM SR 1453 ELCANIE RD TO END OF MAINTENANCE	4	2	2WU	0.740	22	0.000	0.740	1	15	9,600.00			8,640	
TOTAL FOR MAP NO. 26								0.740				1	15	9,600.00			8,640	
2026CPT.08.07.20632	Moore	27	SR-1453 / ELCANIE RD	FROM SR 1425 BROWNS MILL RD TO SR 1454 LINEBERRY RD	2	2	2WU	0.740	22	0.000	0.740	1	20	9,551.00	9,551.00		5,253	
TOTAL FOR MAP NO. 27								0.740				1	20	9,551.00	9,551.00		5,253	
2026CPT.08.07.20632	Moore	28	SR-1415 / ASBURY RD	FROM SR 1414 CAGLE RD TO SR 1412 UPPER RD	1	2	2WU	1.120	22	0.000	1.120	1	25	14,500.00			7,975	
TOTAL FOR MAP NO. 28								1.120				1	25	14,500.00			7,975	
TOTAL FOR PROJ NO. 2026CPT.08.07.20632								19.000				16	393	9,600.00	189,101.00	16,851.00	42,700.00	146,006
GRAND TOTAL								26.410				32	735	9,600.00	247,890.00	35,290.00	81,200.00	209,141

12.00

